

DIMENSIONS FOR REFERENCE ONLY:

USE TO VALIDATE MOUNTING CLEARANCES AROUND PASS THROUGH GROUND LUG.

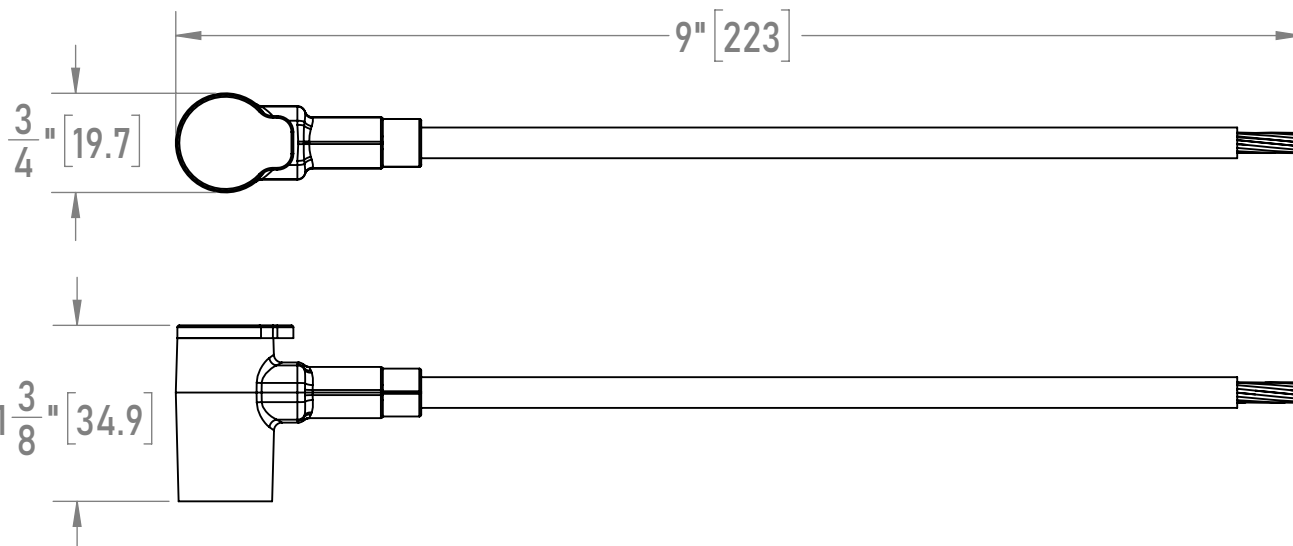

SEALING

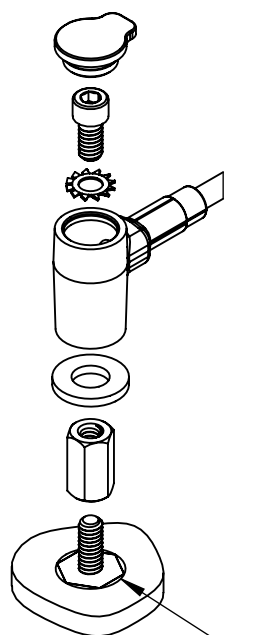

MAX SEALING
SURFACE COVERAGE
 ϕ 23/32" (18.5mm)

END OPTIONS

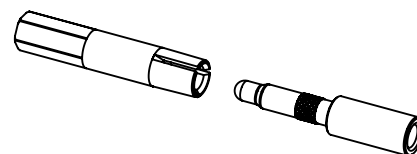

QUICK DISCONNECT
(#6QDK)

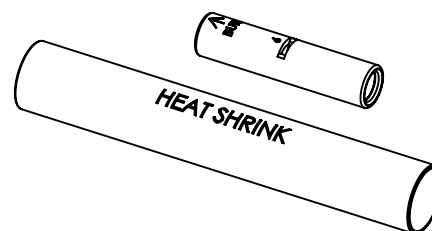

CRIMP AND HEAT SHRINK

PART NO.:

UIT-11419

DESCRIPTION:

UNIVERSAL ISOLATION TERMINAL

REV:

PROPRIETARY

THE INFORMATION CONTAINED IN THIS DRAWING IS THE
SOLE PROPERTY OF RDC PRODUCTS, LLC. ANY
REPRODUCTION IN PART OR AS A WHOLE WITHOUT THE
WRITTEN PERMISSION OF RDC PRODUCTS, LLC. IS
PROHIBITED.

RDC
PRODUCTS